

REVISION AND CHANGE EFFECTIVITY DATE				
LR.	EDN	DESCRIPTION	DATE	APP'D

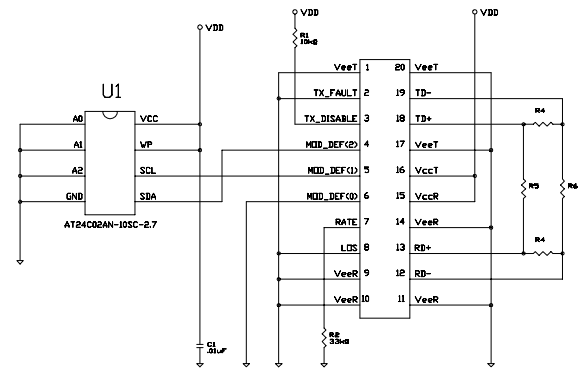
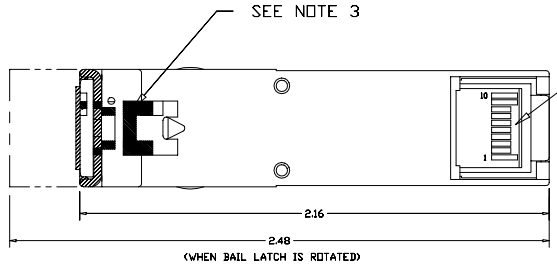
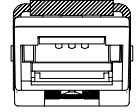
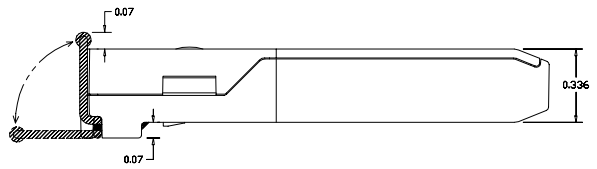
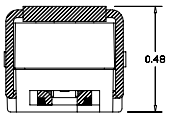
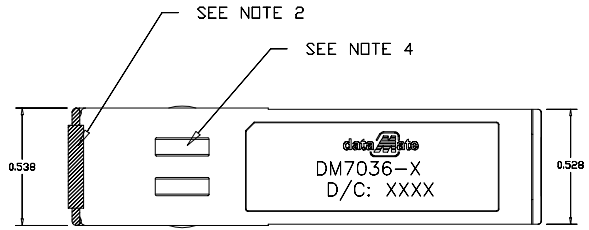
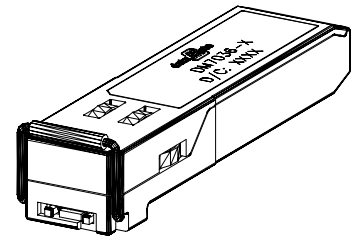

ORDERING INFORMATION

DM7036-X
ATTENUATION IN dB
(OMIT FOR 0 dB)

NOTES:

- HOUSING MATERIAL: ZINC DIE CAST
PLATING: NICKEL OVER COPPER
- BAIL LATCH WIRE: STAINLESS STEEL
SHRINK WRAP: UL 224 VW-1; COLOR: BLACK
- EJECTOR ACTUATOR: ZINC DIE CAST
PLATING: NICKEL OVER COPPER
- GROUNDING TABS: PHOSPHOR BRONZE
PLATING: TIN OVER NICKEL
- PCB-.039" THICK; 15µin. MIN GOLD PLATING OVER
50µin. MIN NICKEL ON CONTACT AREA

DO NOT SCALE DRAWING.

EXPERIMENTAL NO:		DIVISION ASSIGNED: dataMATE Division	
TOLERANCE UNLESS OTHERWISE SPECIFIED		DRAWN BY: B. SKEPNEK	DATE: 3/13/03
* FRACTION ± .010 * DECIMAL XX ± .010 * XXX ± .005 * ANGLES ± * TOOLING DIMS * PART DIMS * BREAK SHARP EDGES * REMOVE ALL BURRS		CHECKED BY: J. LLIRENS	DATE: 3/13/03
MATERIAL:		ENGR. APPROVAL: A. PIRILLIS	TITLE: ATTENUATING SFP LOOPBACK
SEE NOTES		APPROVED BY: T. LEGITTIMO	DATE: 3/13/03
SEE NOTES		PART NO. CLASSIFICATION:	SIZE: C
THE INFORMATION DISCLOSED IN THIS DOCUMENT IS PROPRIETARY TO MERBODE ELECTRONICS, INC. AND MAY NOT BE USED FOR REPRODUCTION OR ANY OTHER PURPOSE WITHOUT THE WRITTEN CONSENT OF MERBODE ELECTRONICS, INC.			
		CODE IDENT.	DWG. NUMBER
			DM7036-X

